

# KEY MAP

## REVISIONS

DATE	L.S. NAME	L.S. LIC. #
08/19/02	PETER C. KIRCH (NJ)	23130
12/31/02	PETER C. KIRCH (NJ)	23130
06/10/03	PETER C. KIRCH (NJ)	23130
12/23/03	PETER C. KIRCH (NJ)	23130
06/30/04	PETER C. KIRCH (NJ)	23130
04/20/05	PETER C. KIRCH (NJ)	23130
11/10/06	PETER C. KIRCH (NJ)	23130
01/06/09	PETER C. KIRCH (NJ)	23130
11/02/10	PETER C. KIRCH (NJ)	23130
04/06/11	PETER C. KIRCH (NJ)	23130
12/31/12	PETER C. KIRCH (NJ)	23130
10/28/13	PETER C. KIRCH (NJ)	23130
09/05/14	PETER C. KIRCH (NJ)	23130
09/23/15	PETER C. KIRCH (NJ)	23130

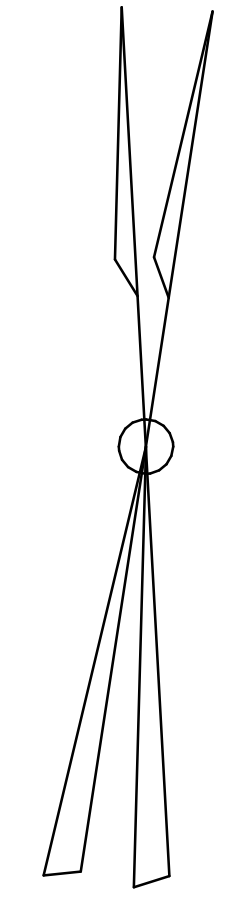
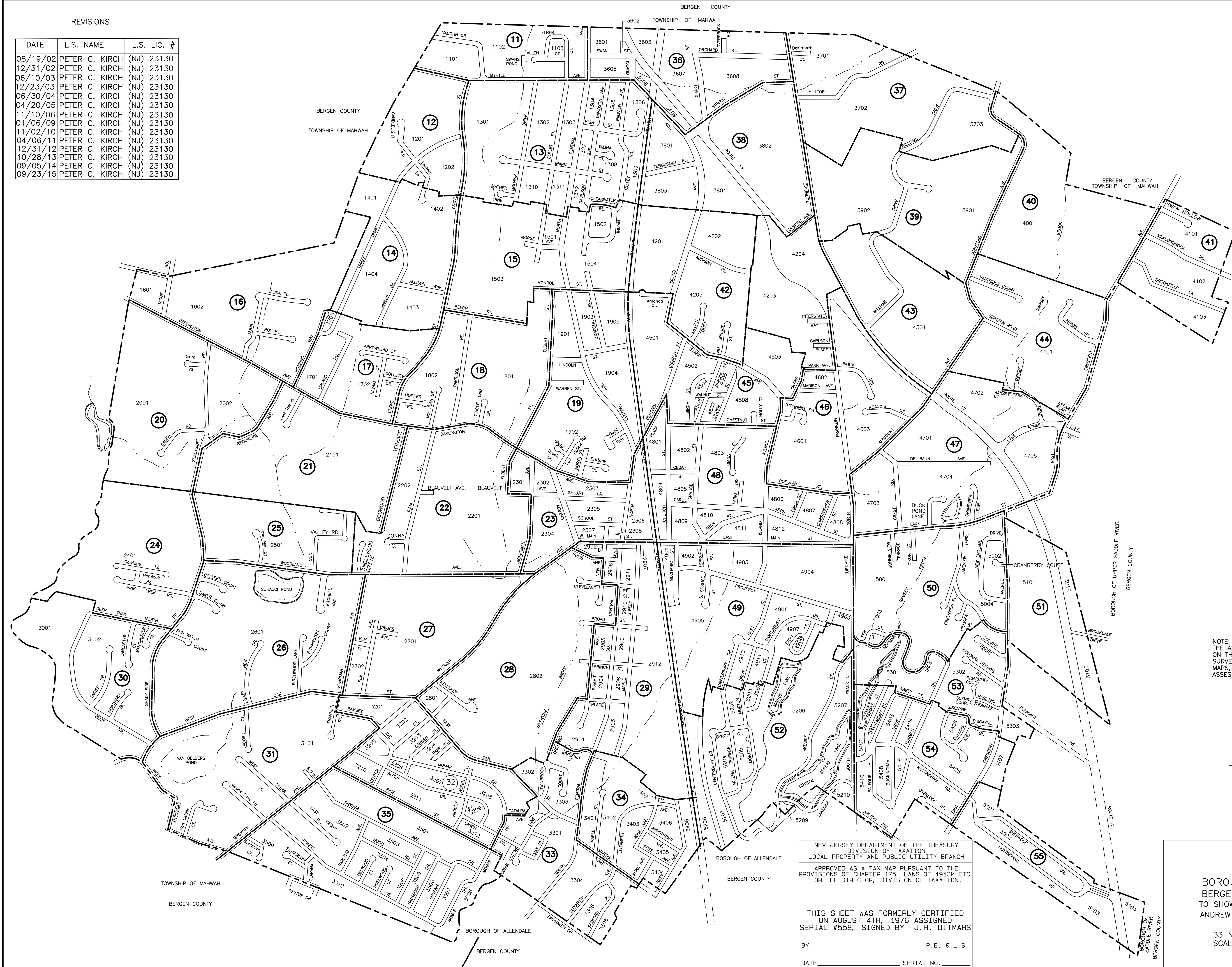

- KEY LEGEND**
- 1234 BLOCK NUMBERS
  - 51 SHEET NUMBERS
  - SHEET LIMITS
  - DETAIL SHEETS
  - 1234 BLOCK NUMBERS
  - - - LOT NUMBERS
  - BLOCK LIMIT LINE

TO SHOW CONDITIONS AS OF SEPTEMBER 23, 2015.

NOTE: THE AREAS, BOUNDARIES AND DIMENSIONS SHOWN ON THIS TAX MAP ARE DERIVED FROM GROUND SURVEYS, AERIAL SURVEYS, AND RECORD PLANS, MAPS, DEEDS, & WILLS & ARE TO BE USED FOR ASSESSMENT PURPOSES ONLY.

THIS TAX MAP SUPERSEDES THE TAX MAP APPROVED JANUARY 9, 1917.

I HEREBY CERTIFY THAT THIS MAP AND THE SURVEY HAS BEEN REVISED UNDER MY IMMEDIATE SUPERVISION AND COMPILES WITH THE LAWS OF THE STATE OF NEW JERSEY.

*Peter C. Kirch*  
 PETER C. KIRCH, P.L.S. #23130

NEW JERSEY DEPARTMENT OF THE TREASURY  
 DIVISION OF TAXATION  
 LOCAL PROPERTY AND PUBLIC UTILITY BRANCH

APPROVED AS A TAX MAP PURSUANT TO THE PROVISIONS OF CHAPTER 175, LAWS OF 1913M ETC FOR THE DIRECTOR, DIVISION OF TAXATION.

THIS SHEET WAS FORMERLY CERTIFIED ON AUGUST 4TH, 1976 ASSIGNED SERIAL #558, SIGNED BY J.H. DITMARS

BY \_\_\_\_\_ P.E. & L.S.  
 DATE \_\_\_\_\_ SERIAL NO. \_\_\_\_\_

## TAX MAP

BOROUGH OF RAMSEY  
 BERGEN COUNTY OF NEW JERSEY  
 TO SHOW CONDITIONS AS OF OCTOBER 28, 2013.  
 ANDREW MARSHALL JR. BOROUGH ENGINEER  
 P.E. & L.S. 14802  
 33 NORTH CENTRAL AVENUE, RAMSEY, N.J.  
 SCALE: 1"=730' DATE: MAY 30, 1975  
 REV. JULY 88